



400 AIRWAYS AVENUE
SAVANNAH, GA 31408

912.964.0514

TO: All Plan Holders
All Construction Plan Rooms
SAC Marketing Department

A handwritten signature in black ink, appearing to read "Mark Denmark", is written over a light gray circular background.

FROM: Mark Denmark
Director of Engineering

DATE: June 9th, 2021

SUBJ: SAC 30587 – Rental Car Facility Improvements
Savannah Airport Commission

Addendum No. 2

Attached please find Addendum No. 2 to the contract documents. All bidders shall acknowledge the receipt of Addendum No. 2 in the place provided in the bid proposal.

JAS
ENCL: SAC 30587 – Addendum No. 2
CC: Engineering Files



SAVANNAH AIRPORT COMMISSION

SAC 30587

RENTAL CAR FACILITY IMPROVEMENTS

ADDENDUM NO. 2

The following amendments, additions, deletions shall be made to the Plans and Specifications. In so far as these documents are at variance with this Addendum No. 2 dated June 9th, 2021, the addendum shall govern:

1. Questions & Answers

2. Revised Concrete Median Details

1. Questions & Answers:

A) Astra Group, Inc.: As notated per Page I-7 of the Instruction to Bidders Sub part D line item 4, we are required to submit an EEO Statement; however there appears to be no Exhibit/Form to include. Should this be a typical company letterhead explaining our EEO Statement?

SAC: See Page I-4, Contractor Affidavit and Agreement.

B) Astra Group, Inc.: As notated per Page I-7 of the Instruction to Bidders Subpart D, line item 5, we are required to submit a Disadvantaged Business Enterprise Requirements (P-12) however this page appears to be missing from the contract documents. Can you please advise?

SAC: The DBE Requirements Section begins on P-12 and ends on P-22. The document required to be submitted with your proposal package is the REVISED DBE Assurance Form (per Addendum No. 1). The DBE Subcontractor List (P-18), the DBE Notification of Intent to Subcontract Form (P-19) are not required until five (5) days after the bid opening and is only required of the apparent low bidder.

C) Astra Group, Inc.: How does the owner wish to account for the hostile materials escalation market? Currently subcontractors are hesitant to hold their pricing beyond 30 days. Is it anticipated the award shall be made within 30 days of the bid submission?

SAC: Per the plans and specifications, bid is required to be held for 90-days beyond the date of bid opening. Typically, Savannah Airport Commission and City of Savannah Approvals are obtained within 30-days, once approved the contractor will be notified to get their Contract, Bonds, and Certificates of Insurance in order. The Contract, Bonds, and Notice to Proceed will all be dated the day of the Pre-Construction Conference.

D) Astra Group, Inc.: Should nighttime work be required, will the contract be responsible for the cost of security guards during “non normal working hours”?

SAC: All Contractor and Subcontract employees requiring access to the SIDA are required to be badged. There will be no need for security guards anywhere even when working on the inside of the AOA. If the Contractor plans to work during non-normal work hours, then a schedule must be presented and approved by the SAC Engineering Department and the SAC Police Department will be notified.

E) Astra Group, Inc.: Could you confirm the Pre-Bid Conference attendance was not mandatory?

SAC: Confirmed, attendance was not mandatory but highly recommended.

F) NetPlanner: Drawing Page E-503 – Note 3 specifies “Contractor to furnish and install (2) 48-strand fiber optic patch panels and (2) 48-port Fiber Optic Network Switches in existing SPOP Network Racks for Camera Data Connection to Airport Network. Network Switch shall be manufactured by Cisco Model No. C9300-48S-E.”

3 CONTRACTOR TO FURNISH AND INSTALL TWO (2) 48-STRAND FIBER OPTIC PATCH PANELS AND TWO (2) 48 PORT FIBER OPTIC NETWORK SWITCHES IN EXISTING SPOP NETWORK RACKS FOR CAMERA DATA CONNECTION TO AIRPORT NETWORK. NETWORK SWITCH SHALL BE MANUFACTURED BY CISCO MODEL NO. C9300-48S-E.

F.1) How many SFP's are required?

SAC: 24 SFP's for each switch will be required.

F.2) Do these SFP's need to be CISCO also, or is a compatible brand acceptable?

SAC: CISCO will be the only acceptable manufacturer.

F.3) The Switches require DNA on a minimum of a 3-year term – does the SmartNet need to match, or does it need to be longer?

SAC: Yes, SmartNet shall match the 3-year minimum term.

G) NetPlanner: Drawing Page E-504 – Note 10 specifies “Provide fiber optic to ethernet converter and power supply per Manufacturer’s recommendation.”

10. PROVIDE FIBER OPTIC TO ETHERNET CONVERTER AND POWER SUPPLY PER MANUFACTURES RECOMMENDATION. INSTALLED IN JUNCTION BOX ATTACHED TO CANOPY STRUCTURE, REFER TO SITE PLAN SHEET FOR LOCATIONS.

SAC: The note should read, “PROVIDE FIBER OPTIC TO ETHERNET CONVERT AND POWER SUPPLY, INSTALL PER MANUFACTURER’S RECOMMENDATION.”

H) NetPlanner: Are we to supply the fiber to ethernet converter or will this be supplied by the Security Camera Vendor?

SAC: Contractor shall furnish and install cameras, fiber to ethernet converter, power supply, junction box, network switch, patch panels, conduit and cable required for a complete and operational system.

2. Revised Concrete Medial Details (follow).



ISSUED FOR BID
APRIL 30, 2021

RENTAL CAR FACILITY
IMPROVEMENTS

OWNER :



SAVANNAH HILTON HEAD
INTERNATIONAL AIRPORT
SAVANNAH, GA

6/7/21 ADDENDUM #2

MARK	DATE	DESCRIPTION
COPYRIGHT: CRAWFORD, MURPHY & TILLY, INC. 2021		
PROJECT NO: 19002806-00		
DESIGNED BY: JRC		
DRAWN BY: JRC		
CHECKED BY: JFM		
APPROVED BY: MR		
CAD DWG FILE: 04-C102-SITE_PLAN.DWG		
SHEET TITLE		

SITE PLAN -
NORTH LOT

C-201

SHEET 7 OF 83

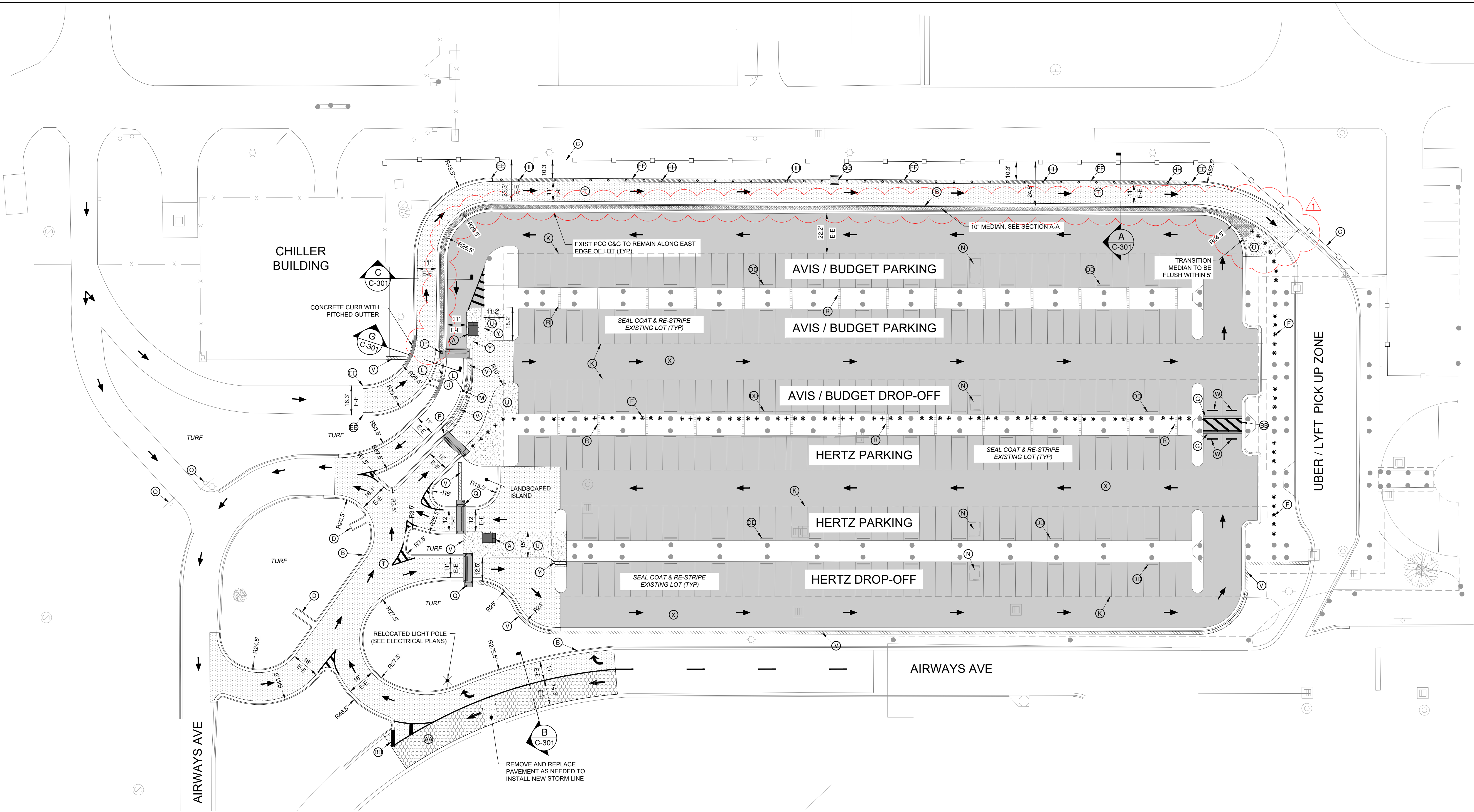

GENERAL NOTES:

- ALL DIMENSIONS ARE TO THE FACE OF CURB UNLESS OTHERWISE NOTED.
- UNLESS MODIFIED BY THE PROJECT SPECIFICATIONS, ALL WORK SHALL BE DONE IN ACCORDANCE WITH THE "STANDARD SPECIFICATIONS CONSTRUCTION OF TRANSPORTATION SYSTEMS", ADOPTED BY THE GEORGIA DEPARTMENT OF TRANSPORTATION, LATEST EDITION; THE LATEST ADDITION OF THE "MANUAL ON UNIFORM TRAFFIC CONTROL DEVICES FOR STREETS AND HIGHWAYS", AND THE CITY OF SAVANNAH, GA "TECHNICAL SPECIFICATIONS". DELETE ALL REFERENCES TO METHOD OF PAYMENT AND ENGINEER'S AUTHORITY DURING CONSTRUCTION.
- CONTRACTOR SHALL REFER TO THE ARCHITECTURAL PLANS FOR EXACT LOCATIONS AND DIMENSIONS OF BOOTHS, PRECISE BUILDING DIMENSIONS AND EXACT BUILDING ENTRANCE LOCATIONS. REFER TO ARCH PLANS FOR BOLLARDS AT BUILDINGS.
- CONTRACTOR SHALL COORDINATE AND SCHEDULE ALL WORK WITH WORK BY OTHERS INCLUDING UTILITY COMPANIES.
- ALL WORK AND MATERIALS SHALL COMPLY WITH ALL CITY/COUNTY REGULATIONS/CODES AND O.S.H.A. STANDARDS.
- CONTRACTOR IS RESPONSIBLE FOR ALL RELOCATIONS, INCLUDING BUT NOT LIMITED TO, ALL UTILITIES, STORM DRAINAGE, SIGNS, ETC. AS REQUIRED. ALL WORK SHALL BE IN ACCORDANCE WITH GOVERNING AUTHORITIES SPECIFICATIONS AND SHALL BE APPROVED BY SUCH. ALL COST SHALL BE INCLUDED IN BASE BID.
- CONTRACTOR SHALL REFER TO THE LIGHTING PLANS FOR SITE LIGHTING DETAILS OF THE PARKING LOT.
- CONTRACTOR SHALL PROVIDE FULL-DEPTH SAWCUT AT ALL REMOVAL LIMITS AS REQUIRED TO PROVIDE A CLEAN, NEAT EDGE TO EXISTING PAVEMENT, CURB & GUTTER, SIDEWALKS, ETC. THAT WILL REMAIN.
- CONTRACTOR SHALL PRIME EXISTING STRIPES BLACK PRIOR TO SEAL COATING PARKING LOT.

KEYNOTES

- | | | | | | |
|-----|-------------------------------------------------------------------------------------------------------------------------------------------------------------------------------------------------------------------------------------------------------------------------------------------------------------------|-----|-----------------------------------------------------------------------------------------------------------|------|------------------------------------------------------------------------------------------------------------------------------------------------------------------------------|
| (A) | NEW TICKET BOOTH (SEE ARCHITECT PLANS FOR BOOTH DETAILS AND STRUCTURAL PLANS FOR BOOTH FOUNDATION.) THE CONTRACTOR SHALL COORDINATE THE FINAL BOOTH LOCATION WITH THE OWNER PRIOR TO CONSTRUCTING THE FOUNDATION. CONTRACTOR SHALL PROVIDE AN ISOLATION JOINT BETWEEN THE BOOTH FOUNDATION AND CONCRETE SIDEWALK. | (L) | 3' CONCRETE RUNDOWN OPENING (SEE DETAIL A2/C-701) | (X) | EXISTING ASPHALT TO RECEIVE CRACK REPAIR, PAVEMENT REPAIR, POT HOLE REPAIR, SEAL COAT AND STRIPING |
| (B) | NEW CURB & GUTTER (SEE DETAIL P02/C-701) | (M) | OPENING IN KNEE WALL FOR DRAINAGE | (Y) | SIDEWALK DRAIN (SEE DETAIL A1/C-701) |
| (C) | NEW CLEAR-VU INVISIBLE WALL PANEL (SEE DETAIL SHEET C-706) | (N) | EXISTING BOOTHS (DO NOT DISTURB) | (Z) | NEW CONCRETE PAVEMENT FOR VALET PARKING (SEE DETAIL ON SHEET C-301) |
| (D) | NEW CONCRETE RUNDOWN (SEE DETAIL A2/C-701) | (O) | EXISTING SIGN (DO NOT DISTURB) | (AA) | MILL AND OVERLAY ASPHALT PAVEMENT (SEE DETAIL ON SHEET C-301) |
| (E) | NEW SPEED HUMP (SEE DETAIL D1/C-704) | (P) | 1601 BARRIER GATE WITH 1620 LANE BARRIER ADD-ON BY DKS DOORKING - 12' LANE WIDTH (SEE DETAIL SHEET C-705) | (BB) | PAINTED 24" WHITE SOLID DIAGONAL STRIPES AT 45° 10' CENTER TO CENTER |
| (F) | NEW DECORATIVE BOLLARD (SEE ARCHITECT PLANS) | (Q) | 1601 BARRIER GATE WITH 1620 LANE BARRIER ADD-ON BY DKS DOORKING - 14' LANE WIDTH (SEE DETAIL SHEET C-705) | (CC) | NEW ADA RAMP (SEE DETAIL P06/C-701 AND P06B/C-704) |
| (G) | RELOCATED FENCE BARRIER - CONTRACTOR SHALL REMOVE EXISTING BOLTED PANEL AND REINSTALL AT LOCATION SHOWN | (R) | EXISTING TRENCH DRAIN (DO NOT DISTURB) | (DD) | TEMPORARILY REMOVE AND REINSTALL EXISTING CONCRETE PARKING BLOCKS AS NEEDED TO SEAL COAT AND RE-STRIP EXISTING PARKING LOT |
| (H) | NEW PCC MEDIAN (SEE DETAIL B3/C-702) | (S) | NEW CONCRETE BOOTH SLAB (SEE STRUCTURAL PLANS) | (EE) | TRANSITION CURB HEIGHT FROM 0" TO 6" (SEE DETAIL D8/C-704) |
| (I) | 1610 SURFACE MOUNT SPIKE SYSTEM BY DKS DOORKING WITH ILLUMINATED WARNING SIGNS TO BE MOUNTED ON CONCRETE SURFACE (SEE DETAIL E2/C-705) | (T) | NEW LIGHT-DUTY ASPHALT PAVEMENT (SEE SHEET C-301) | (FF) | CONCRETE GUTTER PER DETAIL D8/C-704 WITH 0" CURB HEIGHT |
| (J) | NEW PCC WALK (SEE DETAIL P03/C-701) | (U) | NEW CONCRETE ISLAND WITH CURB/ SIDEWALK (SEE DETAIL B3/C-702) | (GG) | REMOVE AND REPLACE VAULT LID (SEE DETAIL F3/C-706) |
| (K) | EXISTING CANOPY (DO NOT DISTURB) | (V) | NEW KNEE WALL (SEE ARCHITECT PLANS) | (HH) | NEW 48" TALL WHITE FLEXIBLE SURFACE MOUNTED PLASTIC TRAFFIC DELINEATOR WITH 2 STRIPS OF REFLECTIVE WHITE TAPE SPACED 6' APART AND TO BE LOCATED IN MIDDLE OF CONCRETE GUTTER |
| | | (W) | NEW CONCRETE PARKING BLOCK (SEE DETAIL B1/C-702) | | |

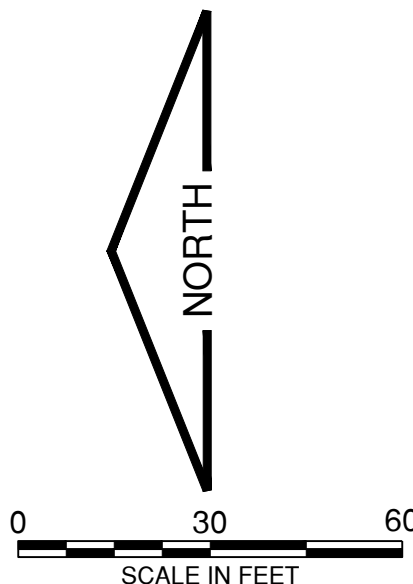

Path: K:\Savannah\Ap20080401-00\Draw\Sheets\CROSS SECTIONS.dwg
Date: Tuesday, June 8, 2021 9:51:03 AM

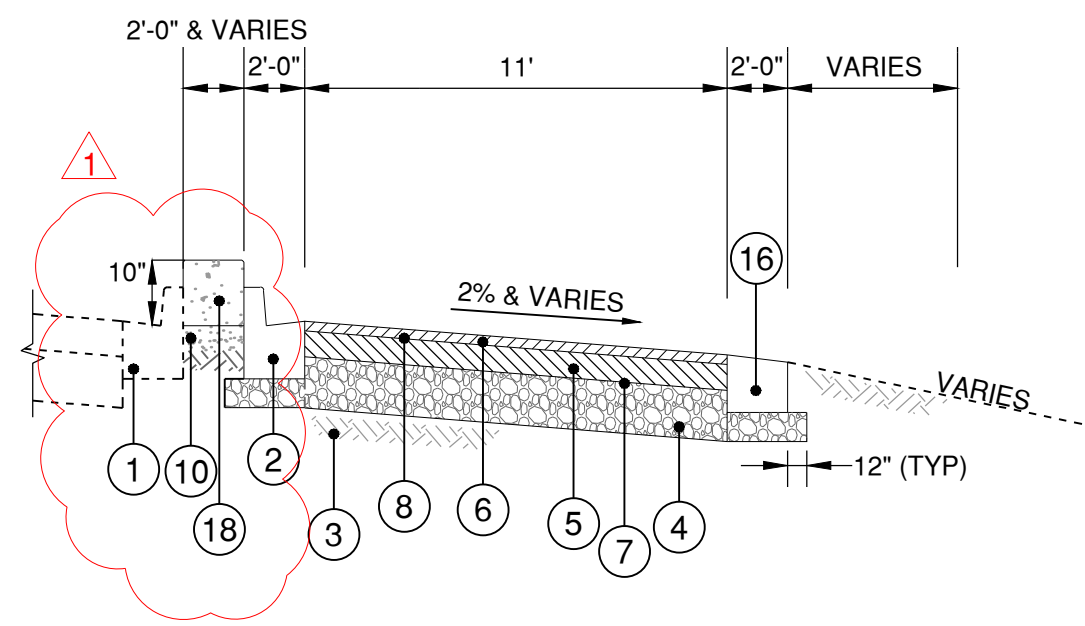

SECTION A-A - UBER / LYFT LANE TYPICAL SECTION

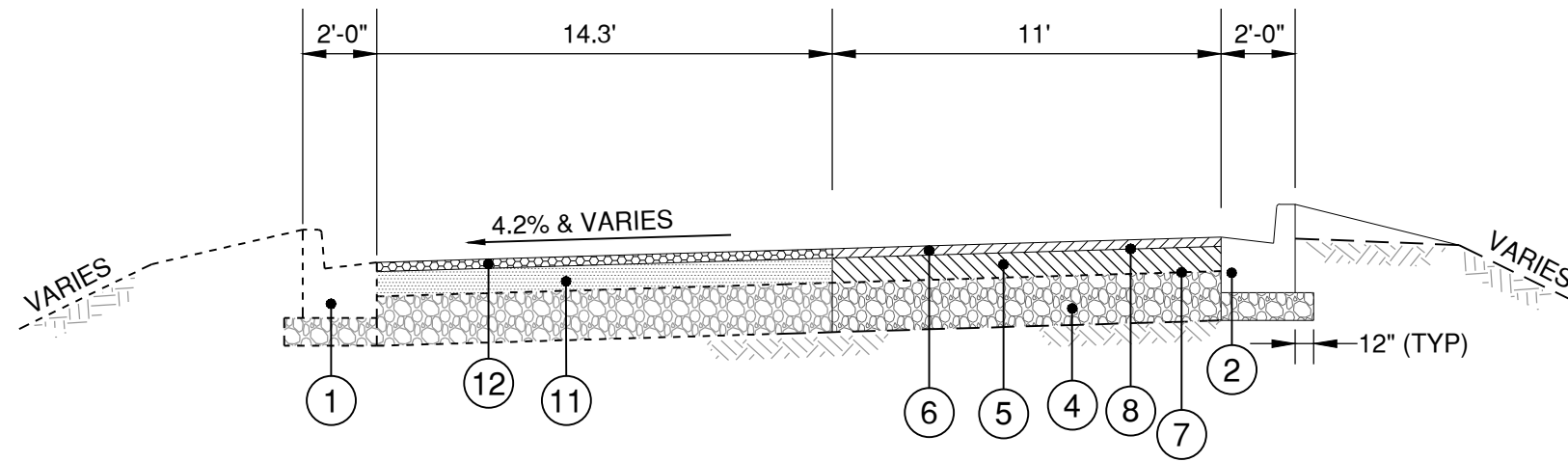

SECTION B-B - AIRWAYS AVE.

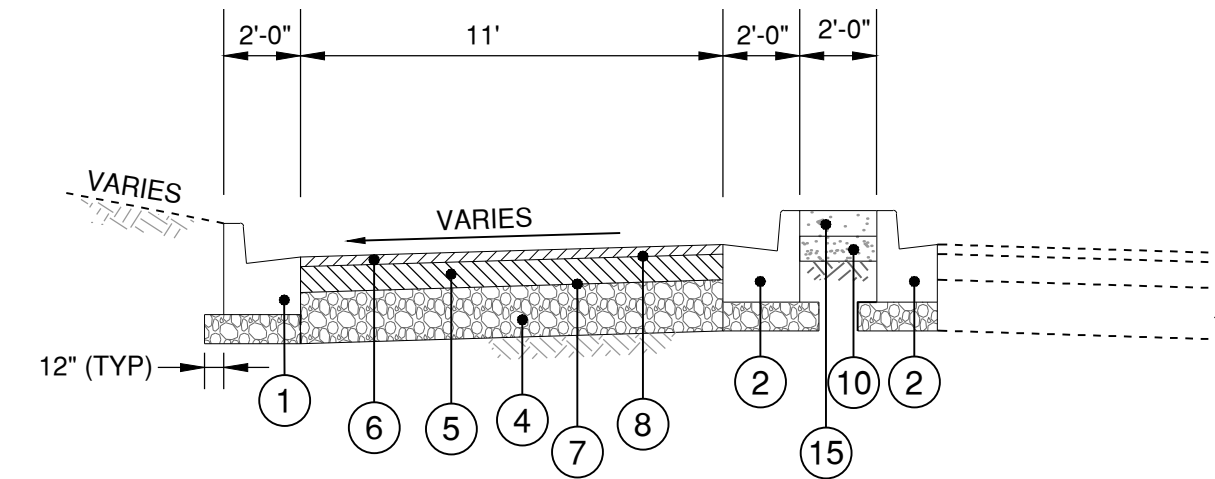

SECTION C-C - UBER / LYFT LANE TYPICAL SECTION

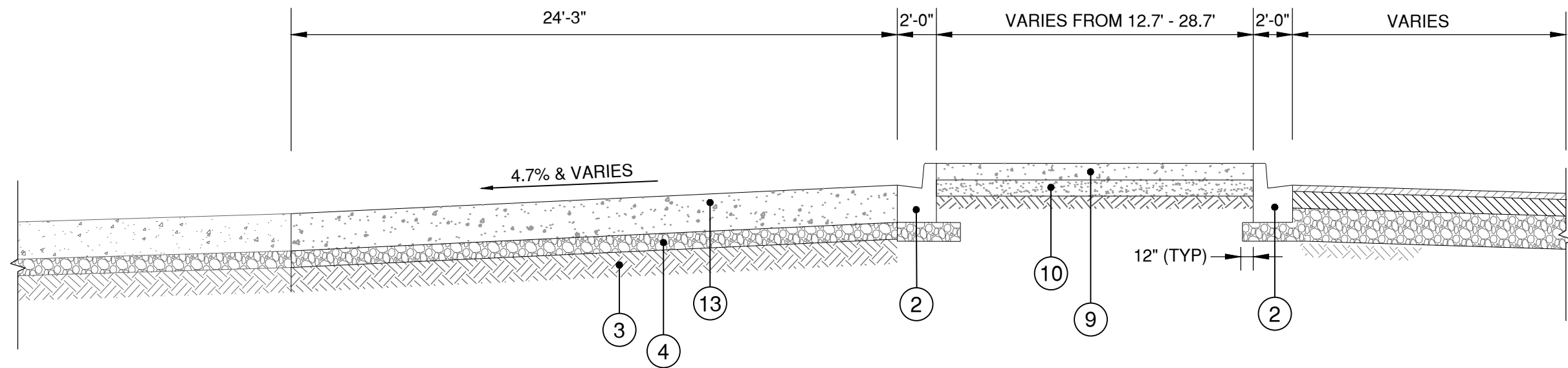

SECTION D-D - VALET PARKING TYPICAL SECTION

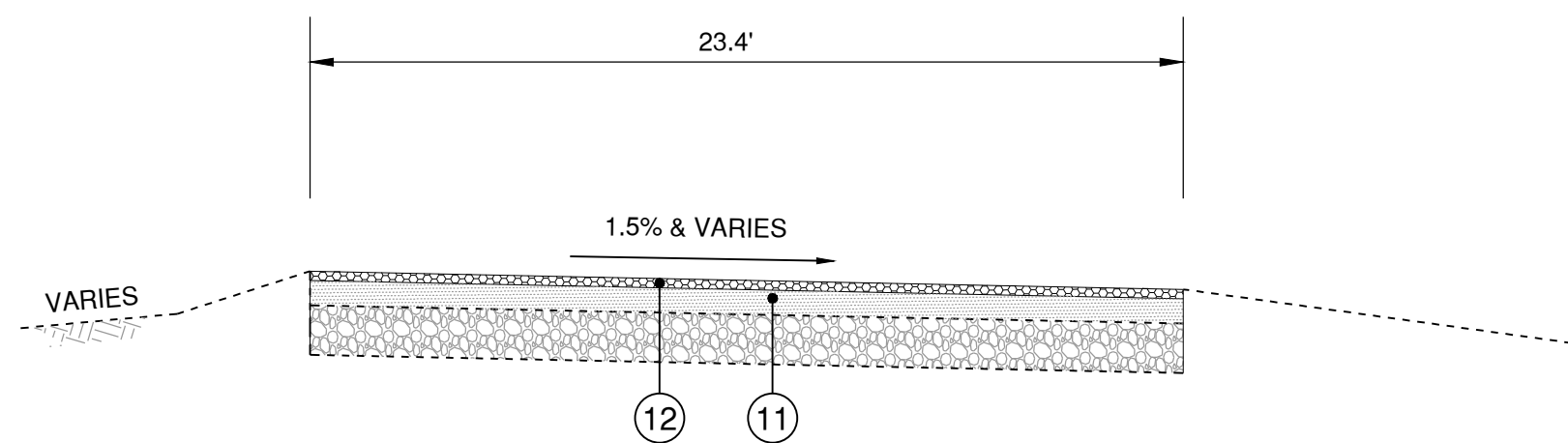

SECTION E-E - MILL & OVERLAY TYPICAL SECTION

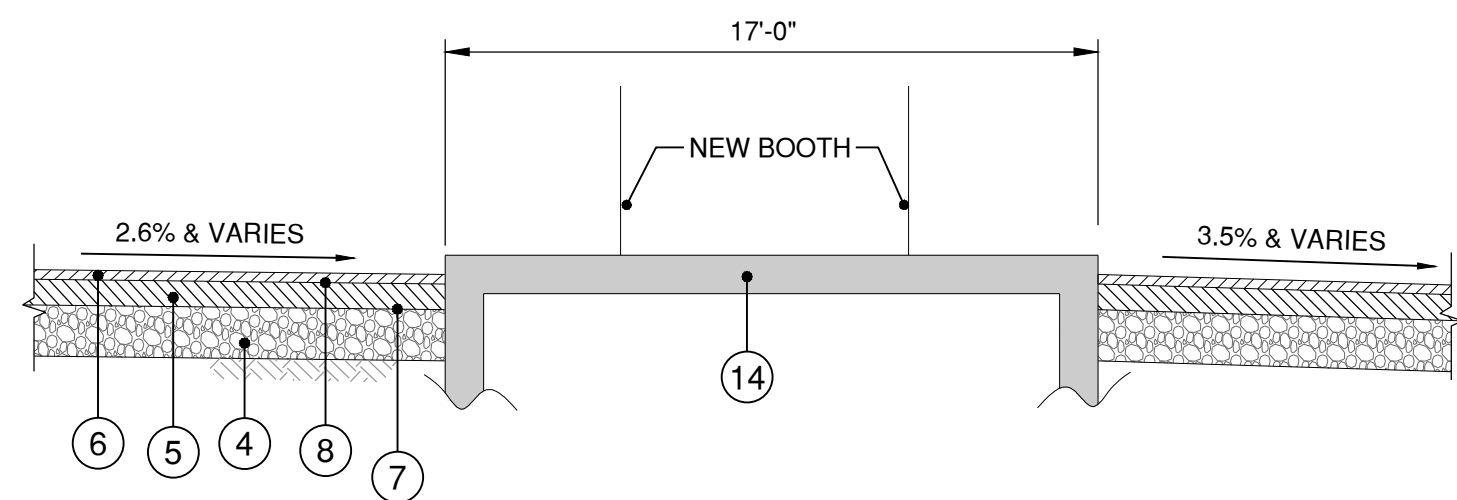

SECTION F-F - SOUTH LOT BOOTH TYPICAL SECTION

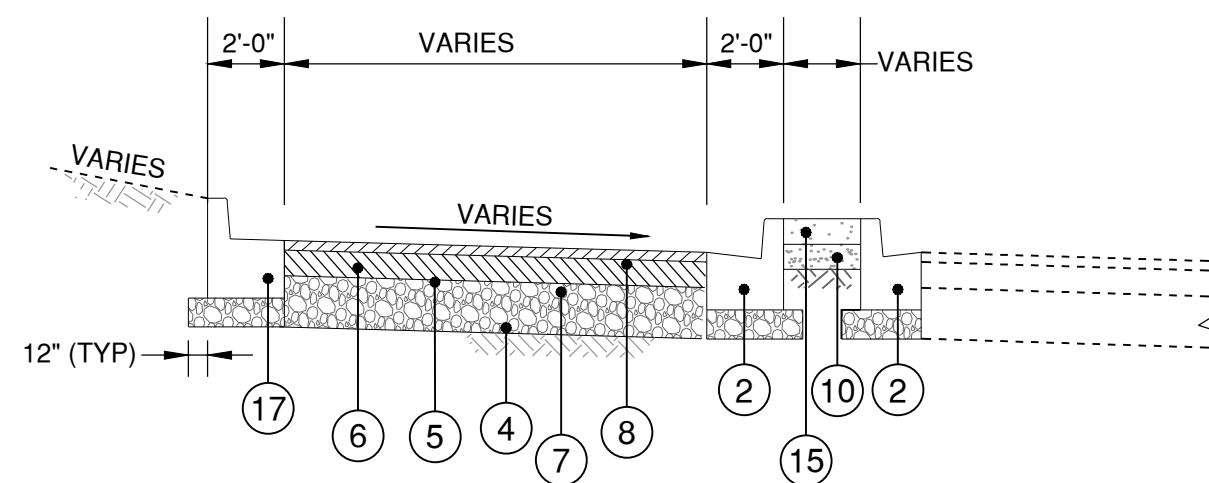

SECTION G-G - UBER / LYFT LANE TYPICAL SECTION

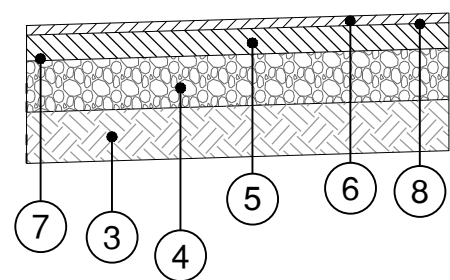

TYPICAL SECTION - LIGHT DUTY ASPHALT PAVEMENT ON NEW BASE

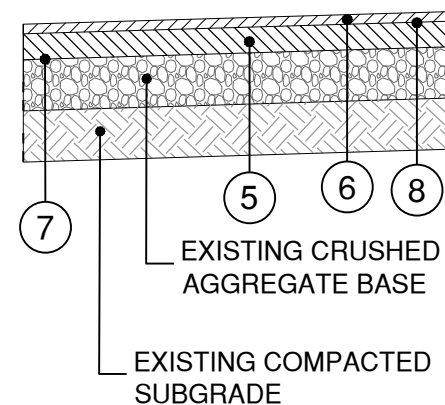

TYPICAL SECTION - LIGHT DUTY ASPHALT PAVEMENT ON EXISTING BASE

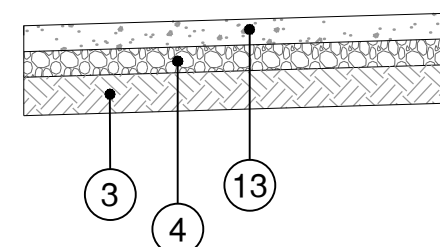

TYPICAL SECTION - CONCRETE PAVEMENT

KEYNOTES:

- EXISTING CONCRETE CURB & GUTTER TO REMAIN
- PROPOSED CONCRETE CURB & GUTTER (SEE P02/C-701)
- PROPOSED 12" COMPACTED SUBGRADE PREPARATION (GDOT 209) (100% ASTM D698)
- PROPOSED 8" GRADED AGGREGATE BASE COURSE (GDOT 310)
- PROPOSED 2" TYPE 19MM BINDER COURSE ASPHALT (P-402B)
- PROPOSED 1-1/2" TYPE 9.5 MM SURFACE COURSE ASPHALT (GDOT 402A)
- PROPOSED BITUMINOUS PRIME COAT (GDOT 412)
- PROPOSED BITUMINOUS TACK COAT (GDOT 413)
- CONCRETE SIDEWALK, 5" (SEE P03/C-701)
- PROPOSED 4" GRADED AGGREGATE BASE COURSE (GDOT 310)
- EXISTING BITUMINOUS BINDER COURSE TO REMAIN
- PROPOSED 1-1/2" MILL OF EXISTING ASPHALT AND PAVE 1-1/2" TYPE 9.5 MM SURFACE COURSE ASPHALT OVERLAY (GDOT 402A)
- PROPOSED 8" PORTLAND CEMENT CONCRETE PAVEMENT (GDOT 430)
- PROPOSED BOOTH FOUNDATION (SEE STRUCTURAL PLANS)
- PROPOSED PCC MEDIAN (SEE DETAIL B3/C-702)
- PROPOSED CONCRETE CURB & GUTTER WITH 0" CURB HEIGHT (SEE P02/C-701)
- PROPOSED CONCRETE CURB & PITCHED GUTTER (SEE P02/C-701)
- PROPOSED 10" CONCRETE MEDIAN

GENERAL NOTES:

- THE SELECT FILL UNDER NEW PAVEMENT SHALL BE PROVIDED BY CONTRACTOR FROM OFF-SITE SOURCE.



CONSULTANTS



ISSUED FOR BID
APRIL 30, 2021

RENTAL CAR FACILITY
IMPROVEMENTS

OWNER :



SAVANNAH HILTON HEAD
INTERNATIONAL AIRPORT
SAVANNAH, GA

6/7/21 ADDENDUM #2

MARK DATE DESCRIPTION

COPYRIGHT: CRAWFORD, MURPHY & TILLY, INC. 2021
PROJECT NO: 19002806-00
DESIGNED BY: JRC
DRAWN BY: JRC
CHECKED BY: JFM
APPROVED BY: MR
CAD DWG FILE: CROSS SECTIONS.DWG

SHEET TITLE

TYPICAL
SECTIONS

C-301

SHEET 9 OF 83

END ADDENDUM NO. 2